

Piano seminterrato

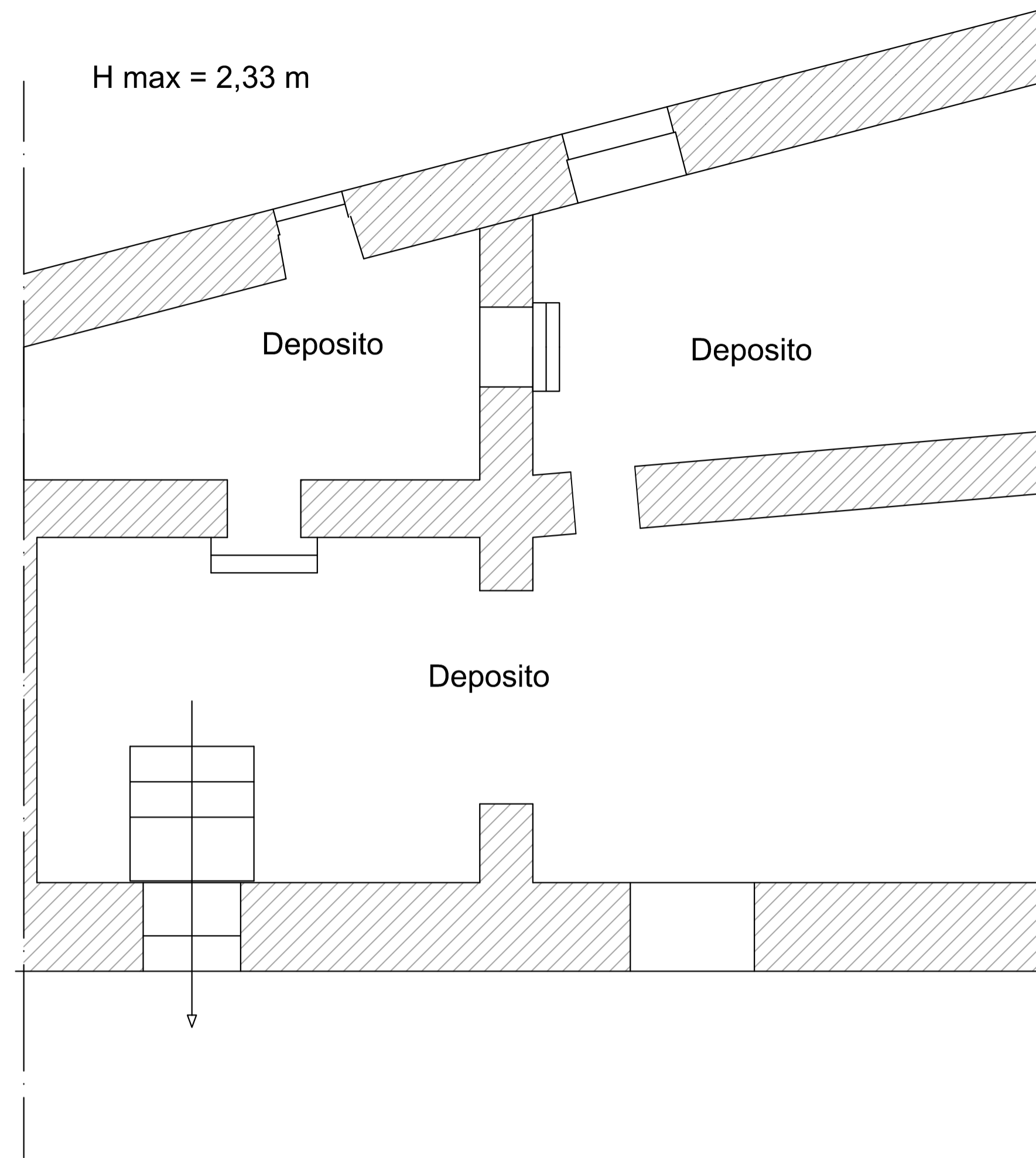

Piano rialzato

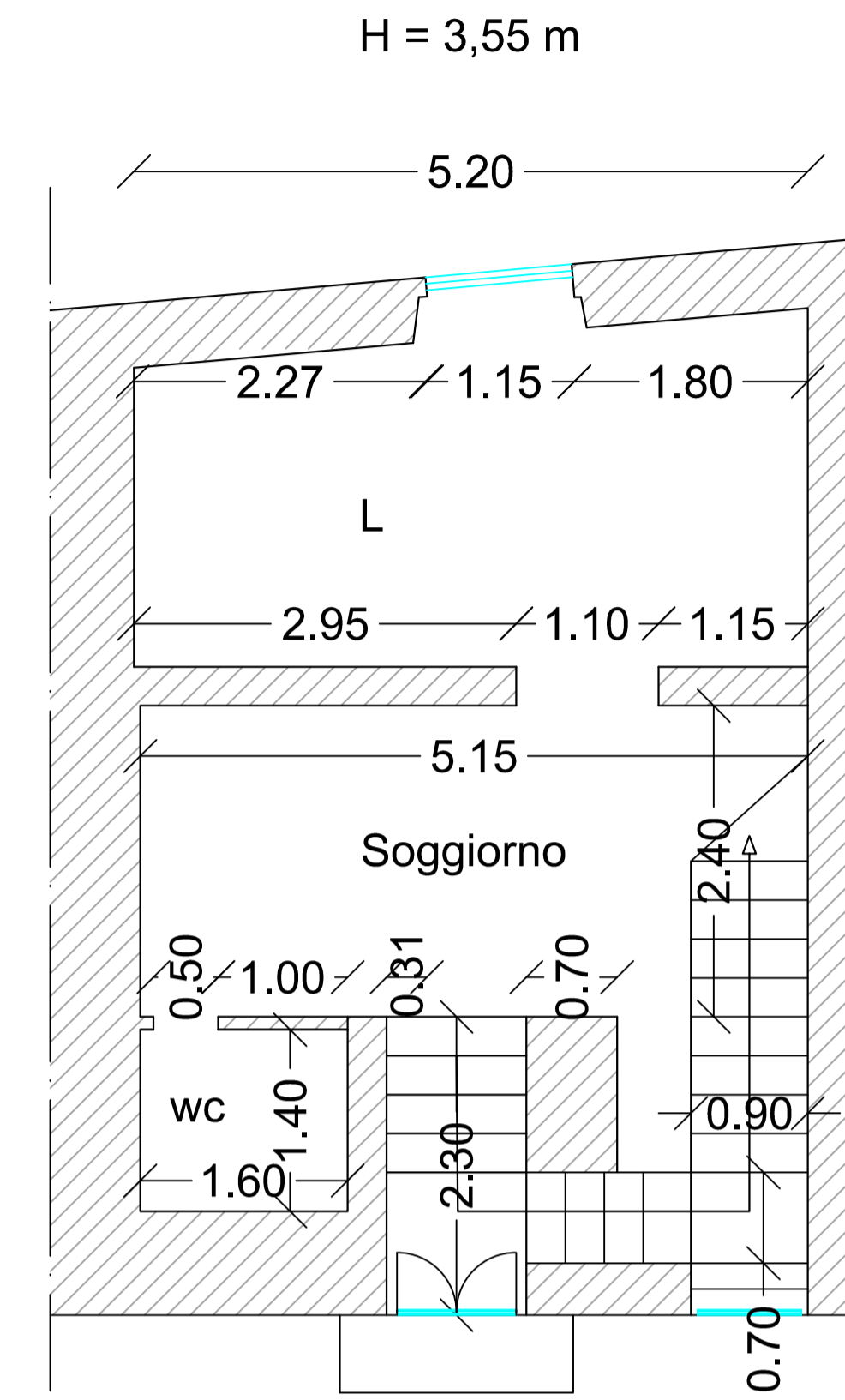

Piano primo

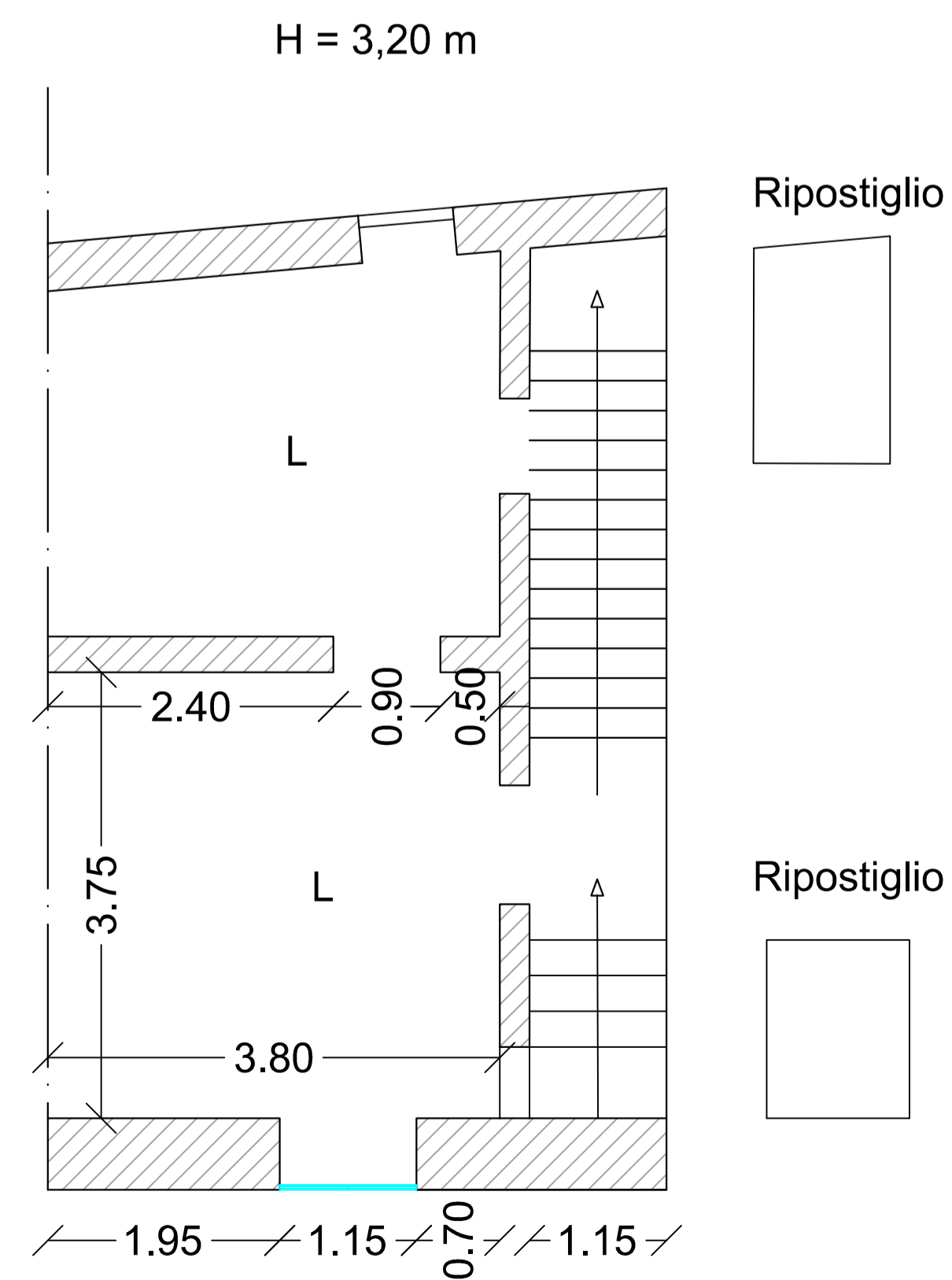

Piano secondo

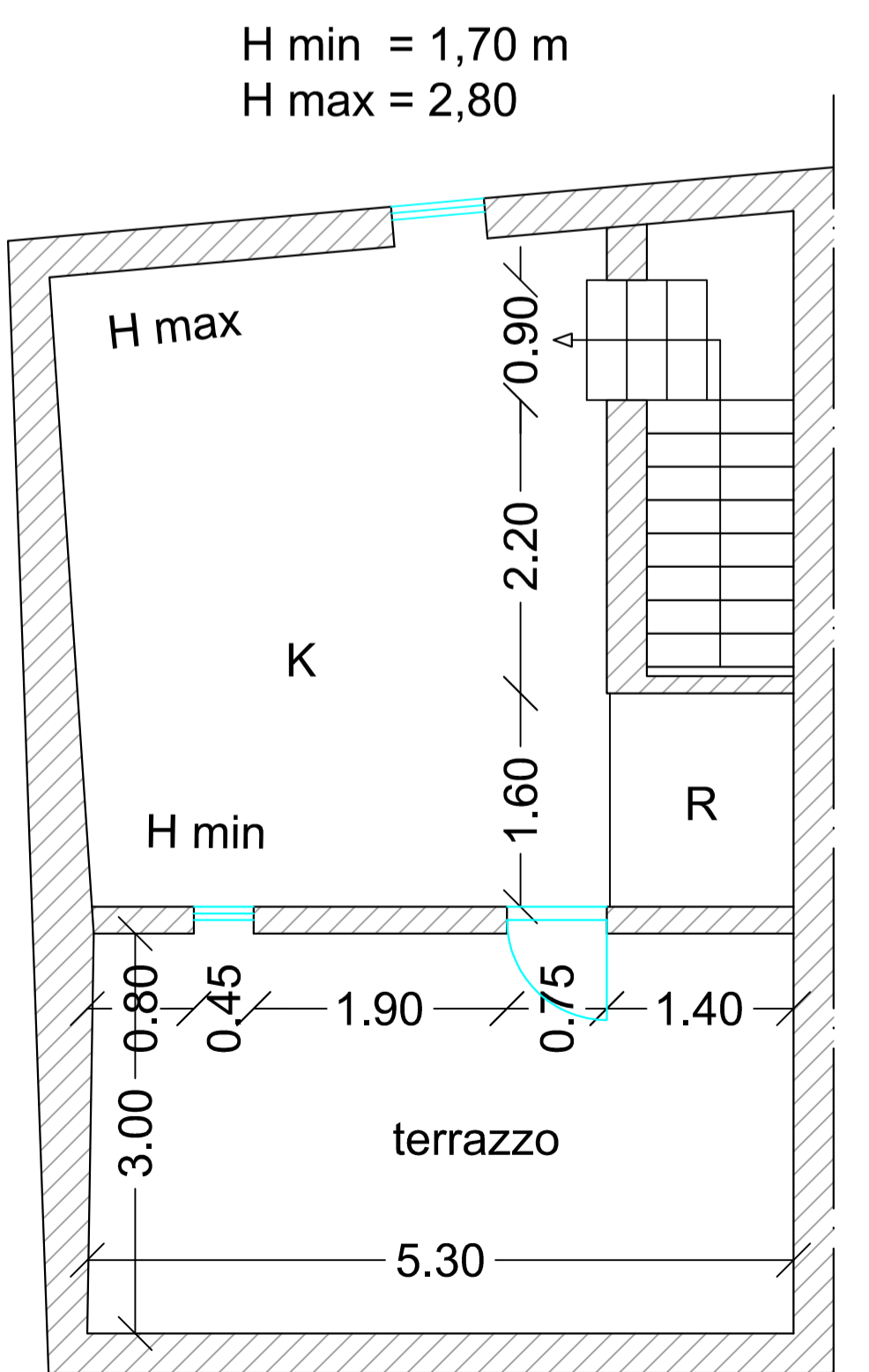

Scala 1:50

COMUNE DI TURI (BA)

TRIBUNALE DI BARI
ESECUZIONE IMMOBILIARE
R.G. 474/2022

Ubicazione: vico San Paolo nn°43-45-50, Turi (BA)

Identificativi catastali: FG: 21 p.lla 433 sub. 1-2

Creditore:
AMCO - ASSET MANAGEMENT COMPANY S.P.A.

Debitore:

G.E.:
dott. Chiara CUTOLO

Perito Incaricato
ing. ANNA DAMIANI

Firmato ANNA DAMIANI Insieme Di ARUBARPEC EU QUALIFIED CERTIFICATE CAGI Serial: 681226661256