

# TRIBUNALE DI FOGGIA

Esecuzioni Immobiliari

*Dott. Michele PALAGANO*

**R.G.Es. n. 41/2022**

---

## RELAZIONE DI STIMA



ALLEGATO IV

Rilievo Planimetrico

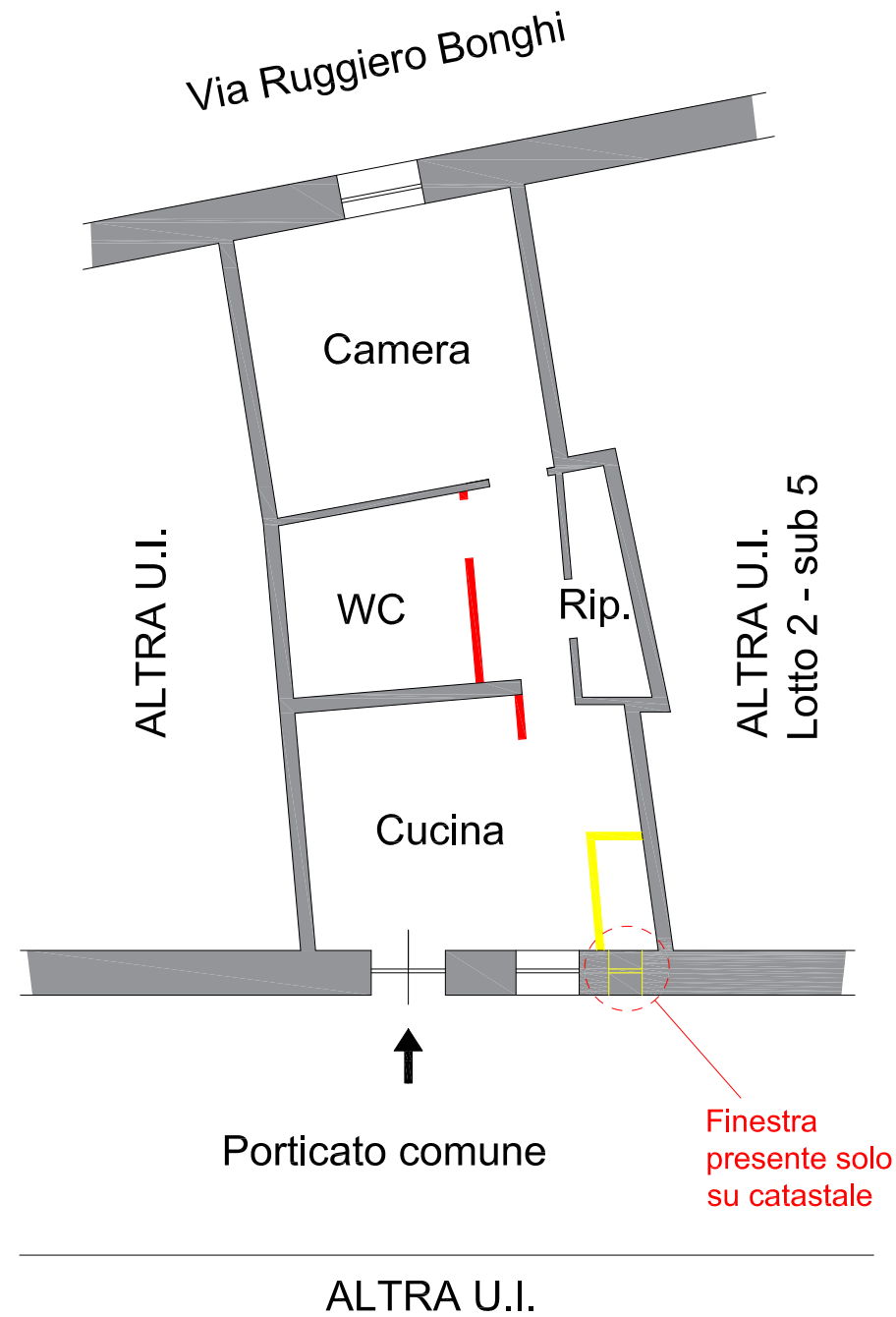

PIANO TERRA  
(h=3,80 m)



-  Tramezzi presenti in sede di sopralluogo ma non su catastale
-  Tramezzi presenti solo su catastale

Firmato Da: RUSSO DANIELE Emesso Da: INFOCAMERE QUALIFIED ELECTRONIC SIGNATURE CA Serial#: 2d08f5

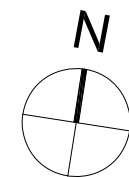



SCALA 1:100

Ing. Daniele Russo  
Via Ruffilli, 3 - 71122 Foggia (FG)  
Email: [ing.d.russo@virgilio.it](mailto:ing.d.russo@virgilio.it)  
Pec: [daniele.russo1@ingpec.eu](mailto:daniele.russo1@ingpec.eu)

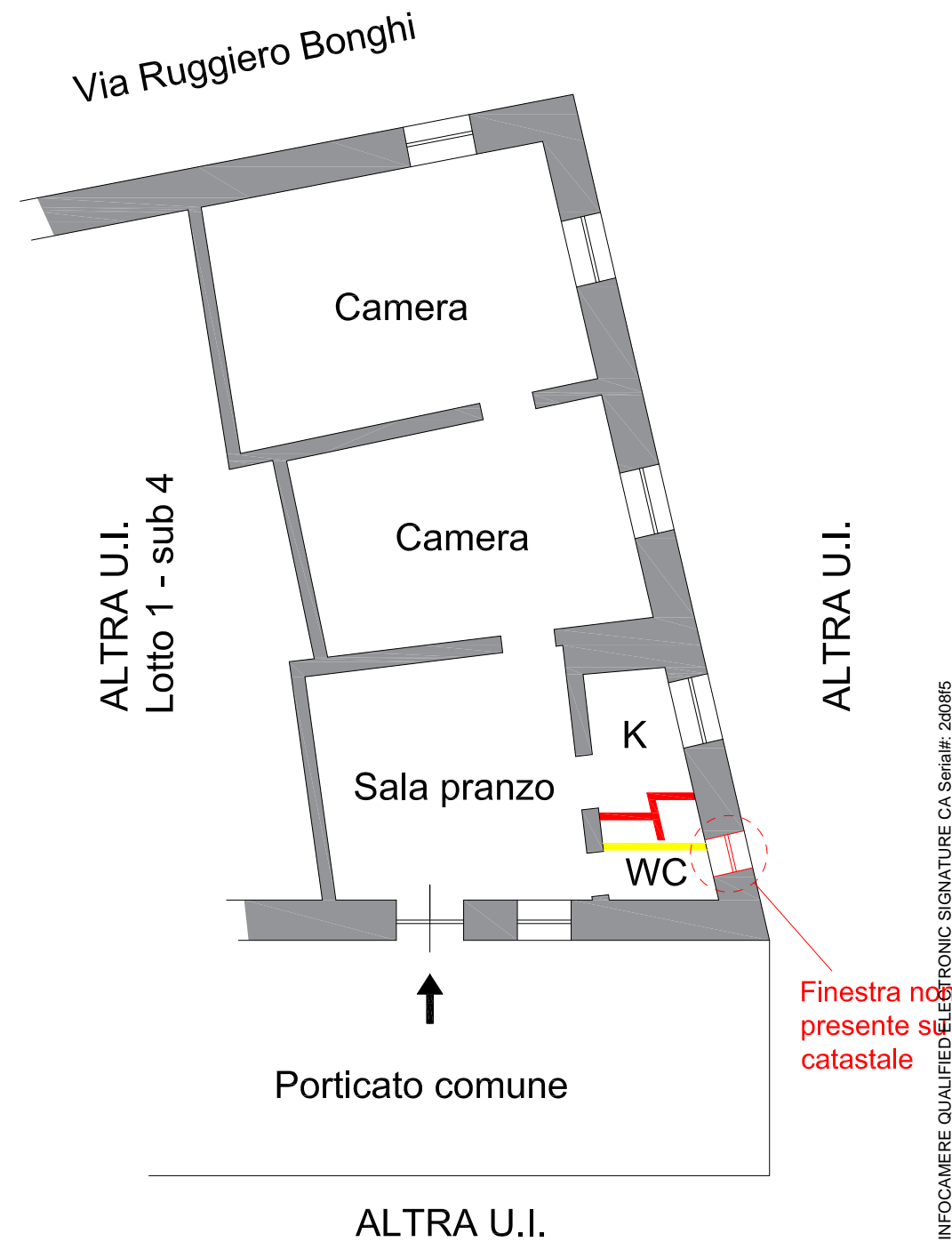

PIANO TERRA  
(h=3,80 m)



-  Tramezzi presenti in sede di sopralluogo ma non su catastale
-  Tramezzi presenti solo su catastale

Finestra non presente su catastale

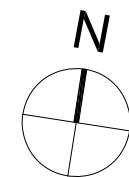



SCALA 1:100

Ing. Daniele Russo  
Via Ruffilli, 3 - 71122 Foggia (FG)  
Email: [ing.d.russo@virgilio.it](mailto:ing.d.russo@virgilio.it)  
Pec: [daniele.russo1@ingpec.eu](mailto:daniele.russo1@ingpec.eu)

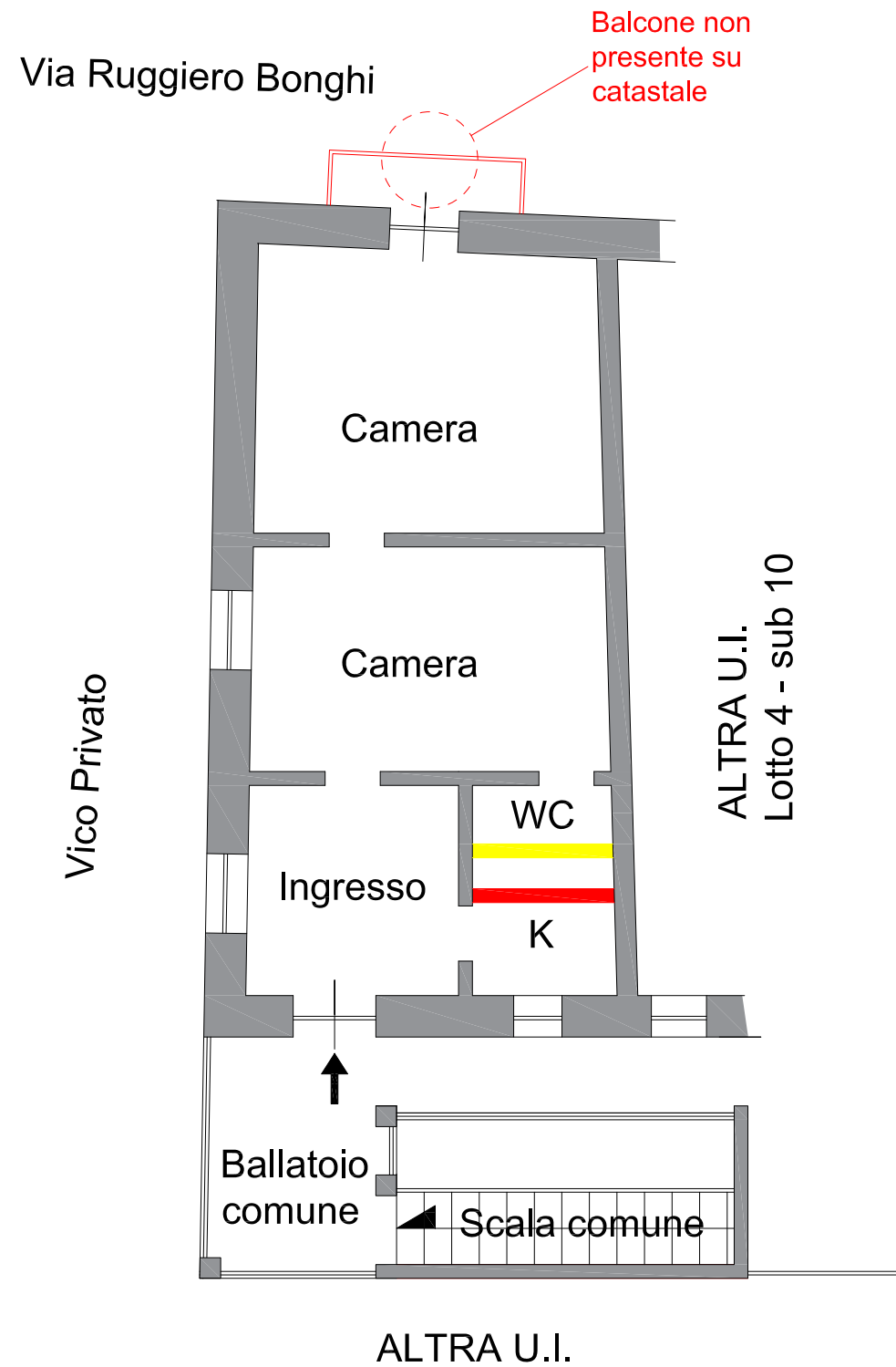

PIANO SECONDO  
(h=4,00 m)



-  Tramezzi presenti in sede di sopralluogo ma non su catastale
-  Tramezzi presenti solo su catastale

Firmato Da: RUSSO DANIELE Emesso Da: INFOCAMERE QUALIFIED ELECTRONIC SIGNATURE CA Serial#: 2d08f5

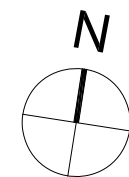



SCALA 1:100

Ing. Daniele Russo  
Via Ruffilli, 3 - 71122 Foggia (FG)  
Email: [ing.d.russo@virgilio.it](mailto:ing.d.russo@virgilio.it)  
Pec: [daniele.russo1@ingpec.eu](mailto:daniele.russo1@ingpec.eu)

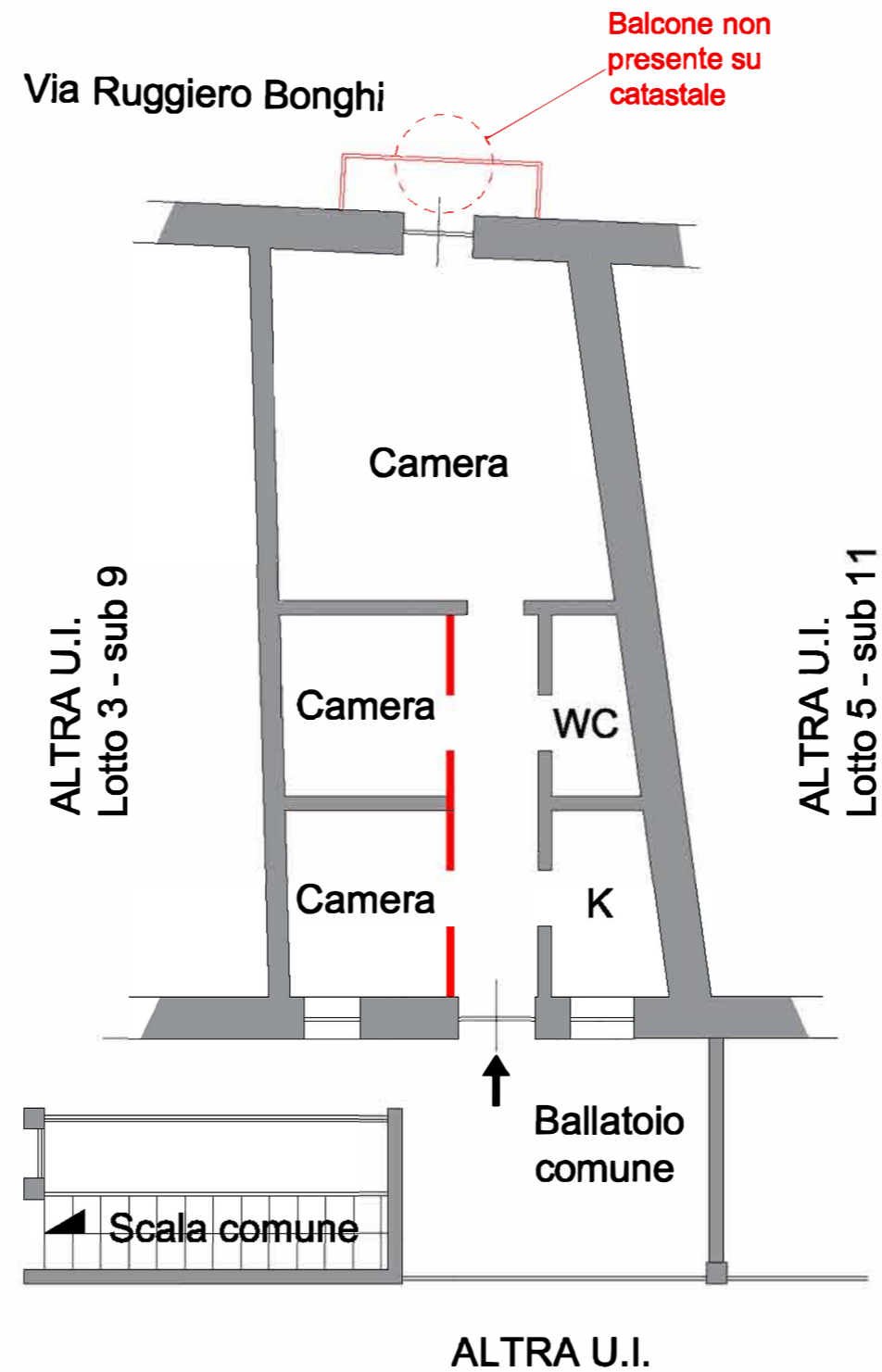

PIANO SECONDO  
(h=4,00 m)



 Tramezzi presenti in sede  
di sopralluogo ma non su catastale



SCALA 1:100

Ing. Daniele Russo  
Via Ruffilli, 3 - 71122 Foggia (FG)  
Email: [ing.d.russo@virgilio.it](mailto:ing.d.russo@virgilio.it)  
Pec: [daniele.russo1@ingpec.eu](mailto:daniele.russo1@ingpec.eu)

PIANO SECONDO  
(h=4,00 m)

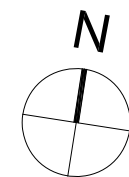
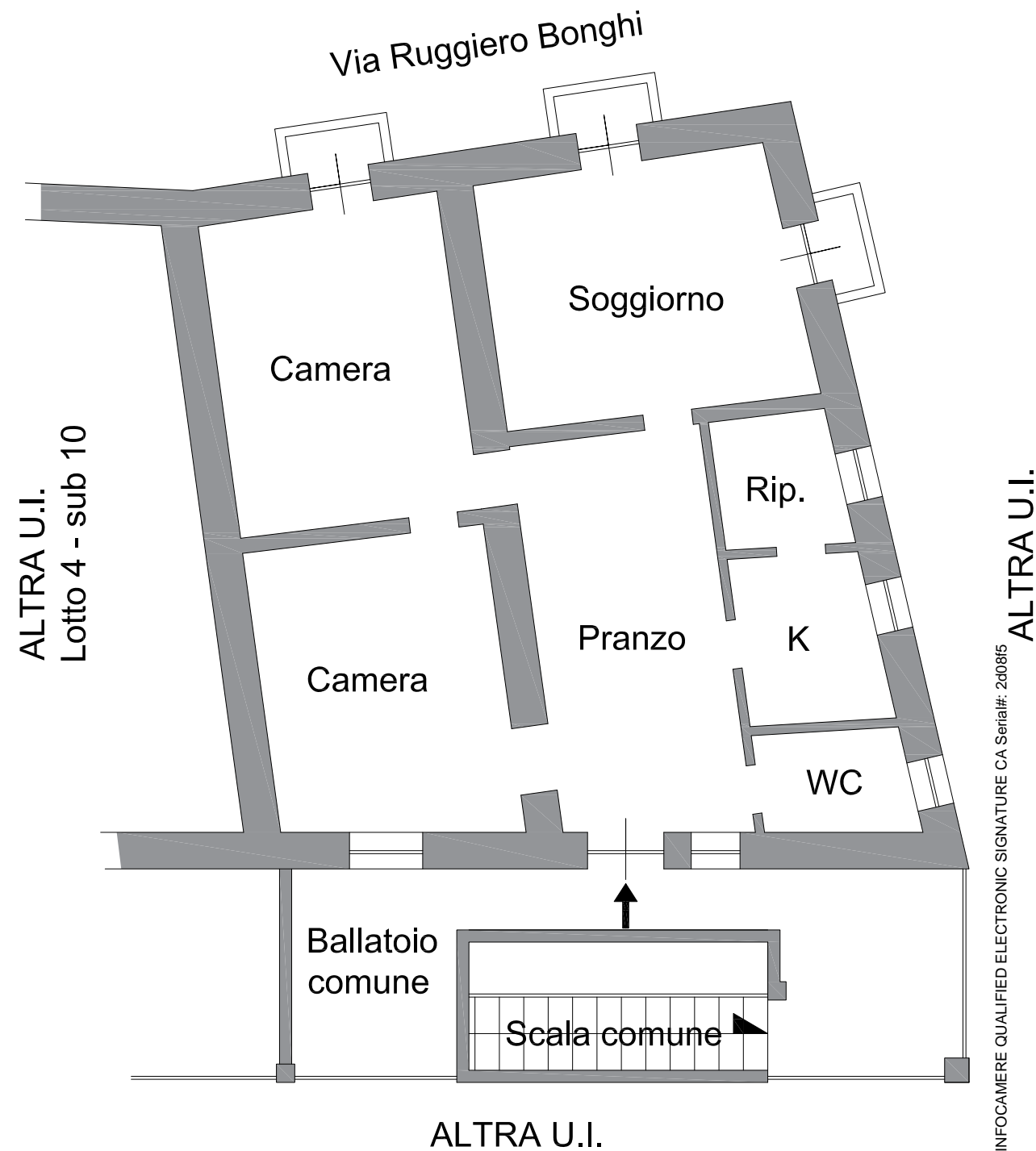

SCALA 1:100



Ing. Daniele Russo  
Via Ruffilli, 3 - 71122 Foggia (FG)  
Email: [ing.d.russo@virgilio.it](mailto:ing.d.russo@virgilio.it)  
Pec: [daniele.russo1@ingpec.eu](mailto:daniele.russo1@ingpec.eu)

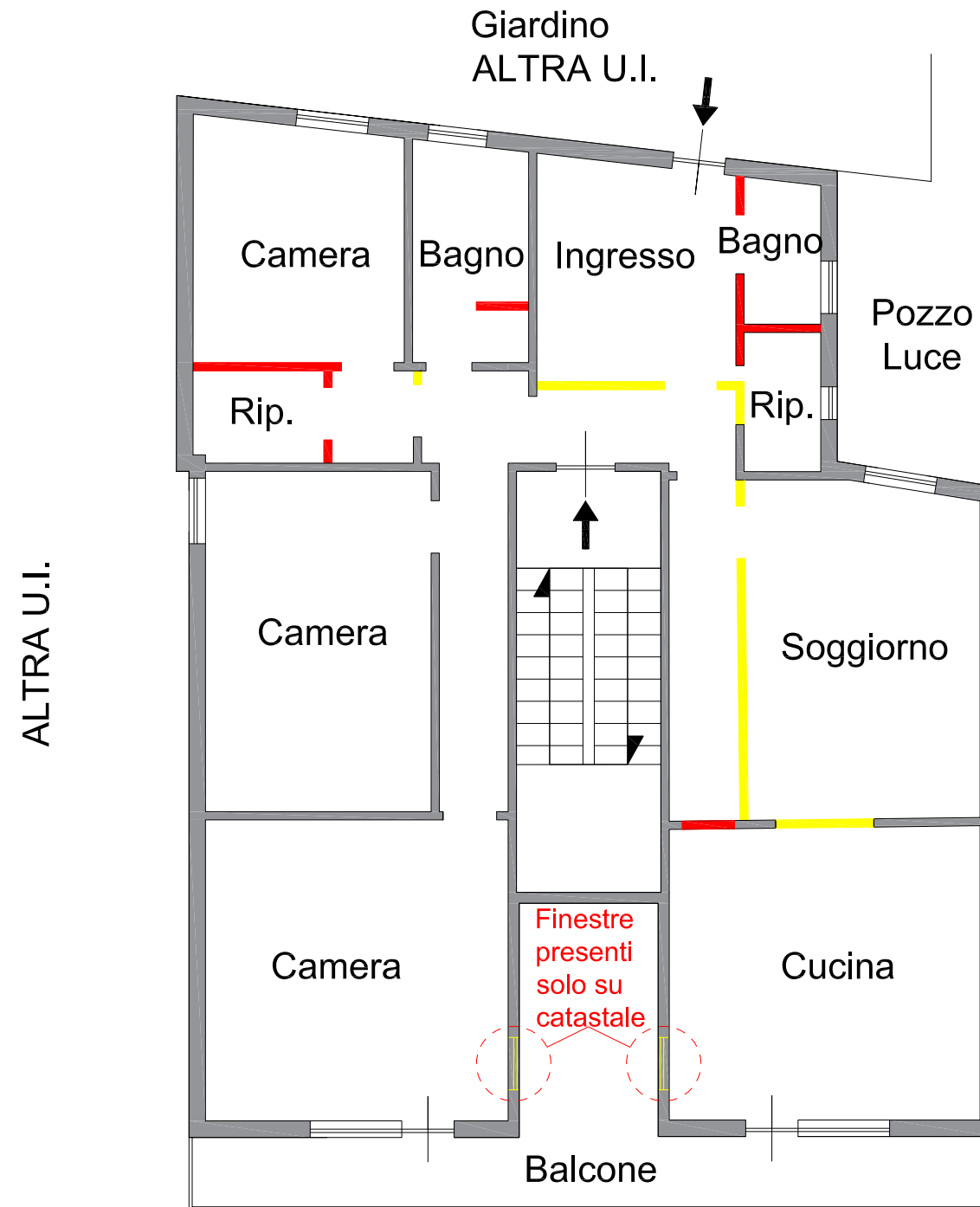

PIANO SECONDO  
(h=3,40 m)



Via Carmine Grossi

-  Tramezzi presenti in sede di sopralluogo ma non su catastale
-  Tramezzi presenti solo su catastale

Firmato Da: RUSSO DANIELE Emesso Da: INFOCAMERE QUALIFIED ELECTRONIC SIGNATURE CA Serial#: 2d008a

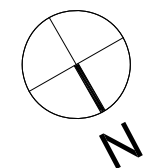

SCALA 1:100

Ing. Daniele Russo  
Via Ruffilli, 3 - 71122 Foggia (FG)  
Email: [ing.d.russo@virgilio.it](mailto:ing.d.russo@virgilio.it)  
Pec: [daniele.russo1@ingpec.eu](mailto:daniele.russo1@ingpec.eu)

