

via Giuliano Boris

Pianta Piano Terra sub 8
h = ml. 4,20

SCALA 1:100

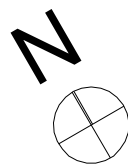

via F. De Roberto

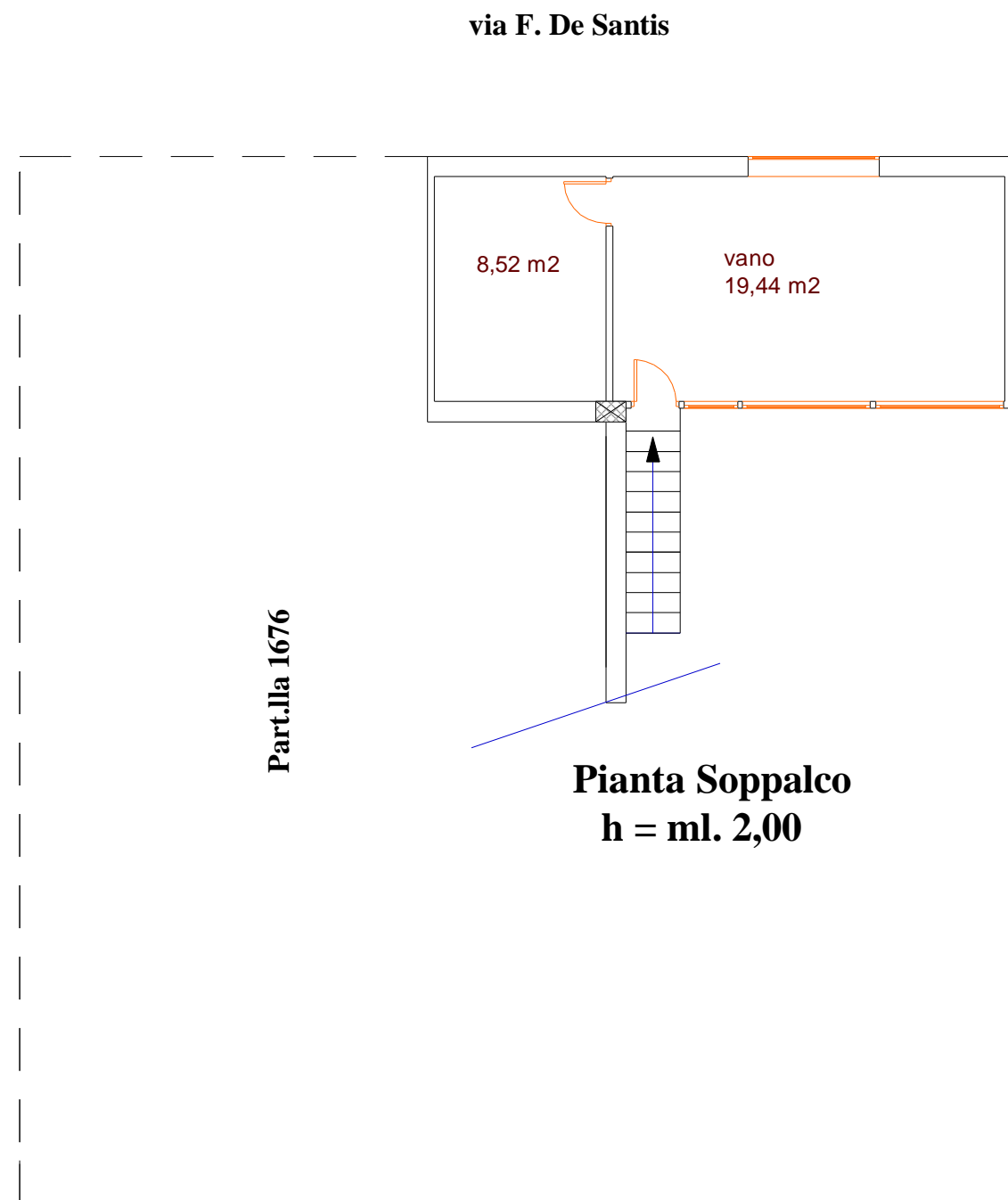

via Giuliano Boris

Pianta Soppalco
h = ml. 2,00

via F. De Roberto

| | | |
|------------------------------------|--------------------------|---------------|
| Superficie Utile Abitabile | mq. | 93,06+ |
| Superficie non Residenziale | mq. 27,96 x 0,60= | 16,77= |
| Superficie Reale Netta | mq. | 109,83 |
| Superficie Reale Lorda | mq. | 104,18 |