

via Giuliano Boris

Pianta Piano Terra sub 9
h = ml. 4,20

SCALA 1:100

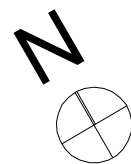

via F. De Roberto

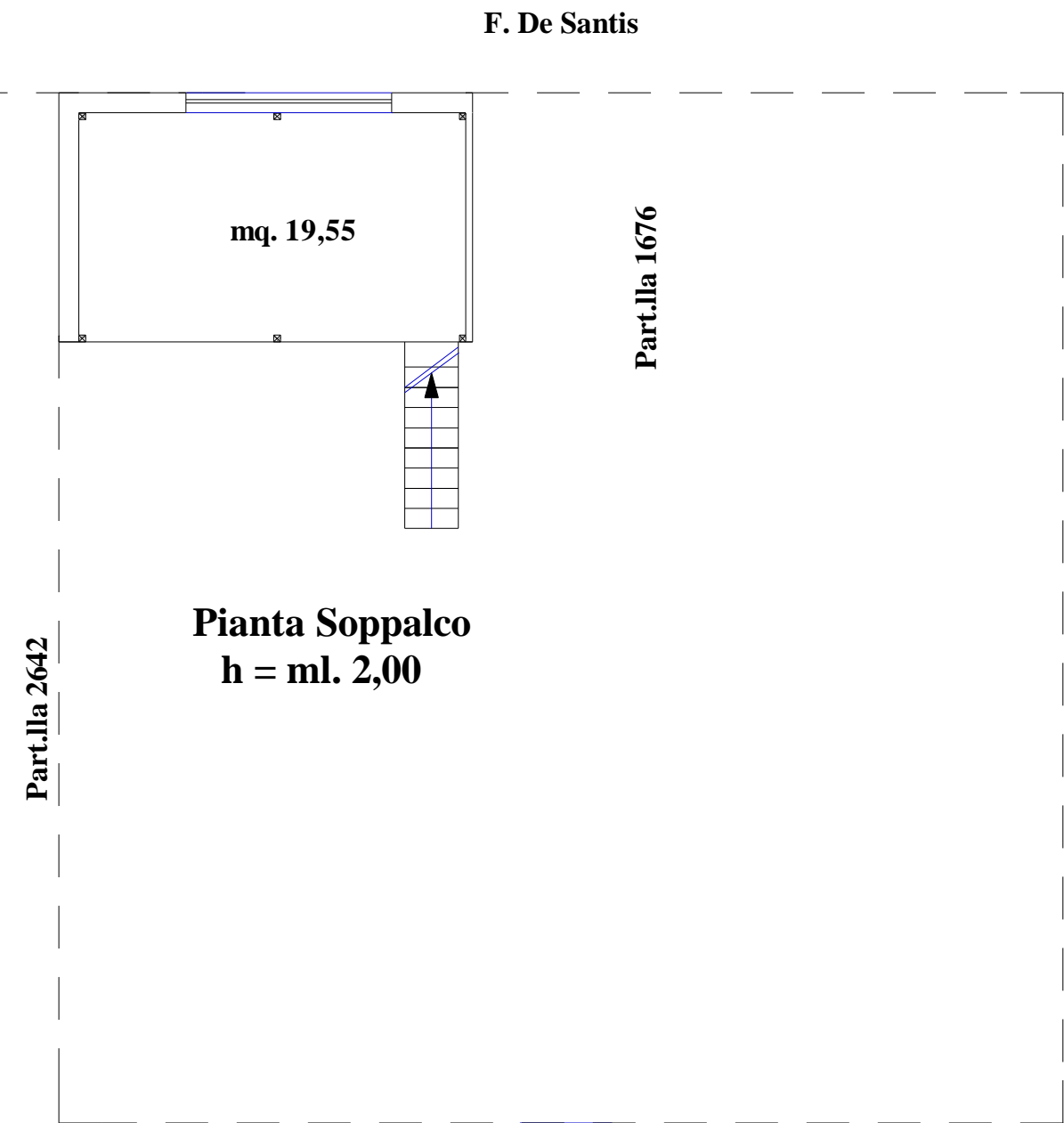

F. De Santis

Pianta Soppalco
h = ml. 2,00

via Giuliano Boris

via F. De Roberto

Superficie Utile Abitabile	mq.	86,08+
Superficie non Residenziale	mq. 19,55 x 0,60=	11,73=
Superficie Reale Netta		mq. 97,81
Superficie Reale Lorda		mq. 94,09