

# IOTESI A.

## CONFIGURAZIONE PLANIMETRICA DELL'IMMOBILE - STATO DI FATTO

PIANO SEMINTERRATO

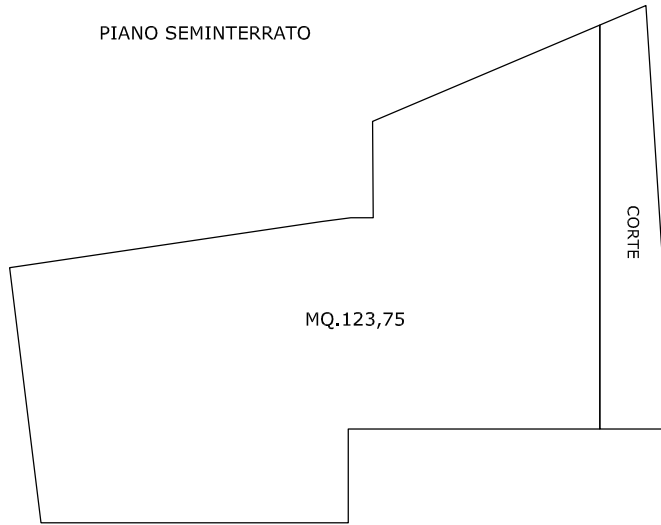

PIANO TERRA

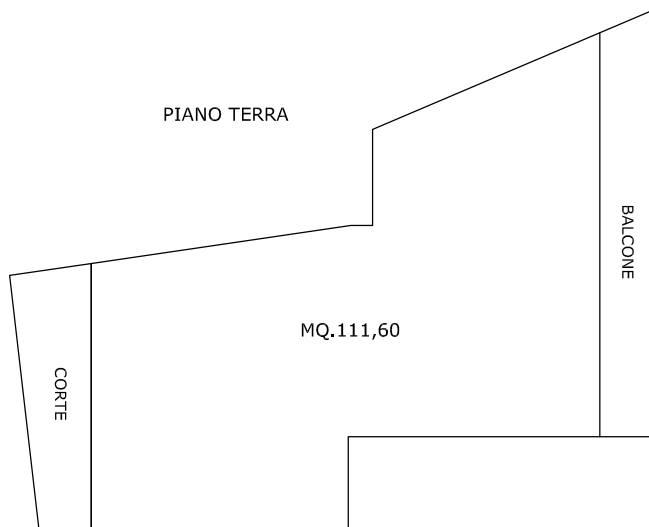

PIANO PRIMO

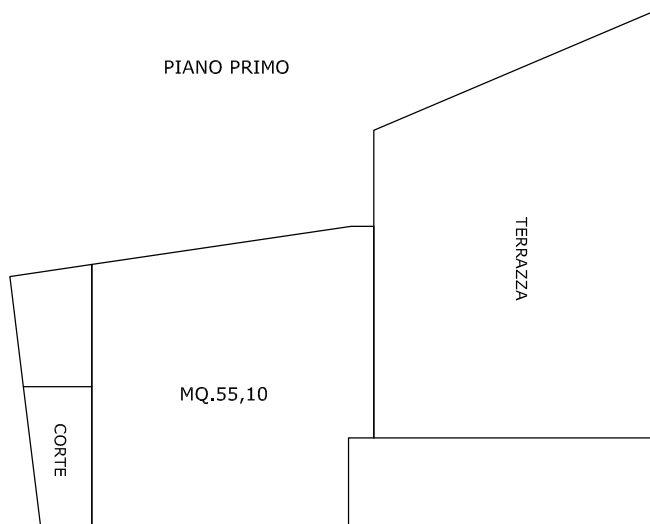

## IPOTESI B.

CONFIGURAZIONE PLANIMETRICA DELL'IMMOBILE - IPOTESI DI DEMOLIZIONE PARZIALE.

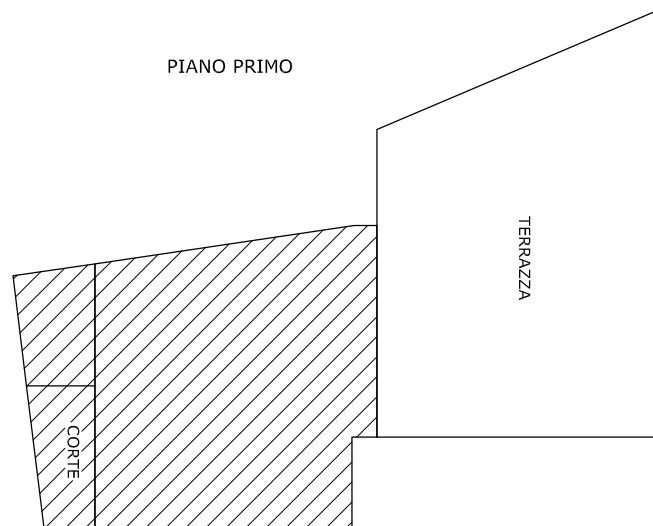
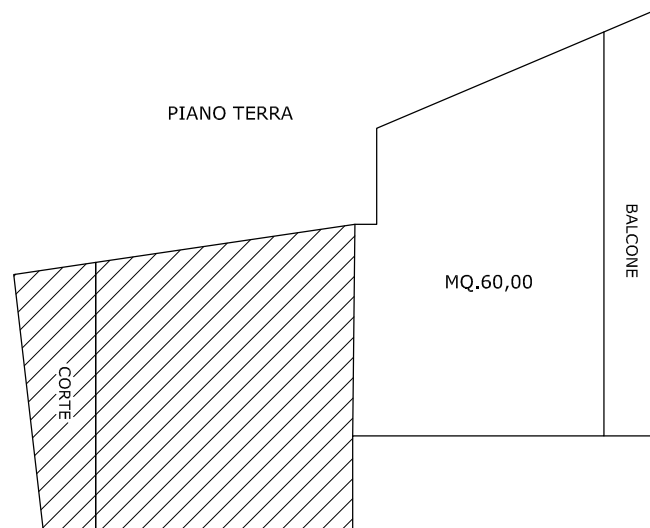
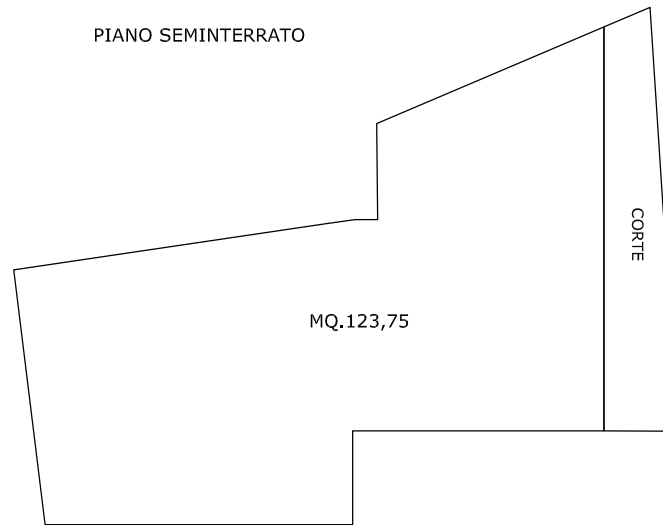

PORZIONE DI FABBRICATO DA DEMOLIRE

### Ipotesi A.

Descrizione	Consistenza	Indice	Commerciale
Piano seminterrato	123,75	35%	43,31
Corte	17,20	10%	1,72
Piano terra	111,60	100%	111,60
Corte	12,30	10%	1,23
Balcone	16,55	25%	4,14
Piano primo	55,10	100%	55,10
Terrazza (tot.mq.73,40)	25,00	35%	8,75
Terrazza (tot.mq.73,40)	48,40	10%	4,84
Corte	6,00	10%	0,60
<b>Totale:</b>	<b>415,90</b>		<b>231,29</b>

### Ipotesi B.

Descrizione	Consistenza	Indice	Commerciale
Piano seminterrato	123,75	35%	43,31
Corte	17,20	10%	1,72
Piano terra	60,00	100%	60,00
Balcone	16,55	25%	4,14
Terrazza (tot.mq.73,40)	25,00	35%	8,75
Terrazza (tot.mq.73,40)	48,40	10%	4,84
<b>Totale:</b>	<b>290,90</b>		<b>122,76</b>