

# PLANIMETRIA DA RILIEVO

COMUNE DI MENDICINO (CS)-C/da Papparuzzo, snc.  
Deposito a Piano Terra e Primo N.C.E.U. Fg.30-P.IIa 395

PIANO TERRA

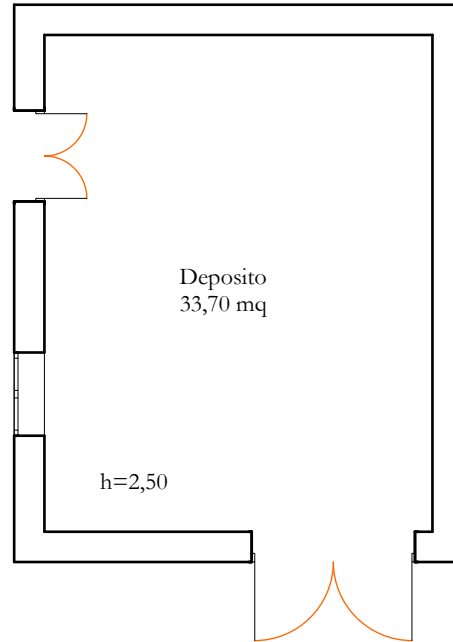

PIANO PRIMO

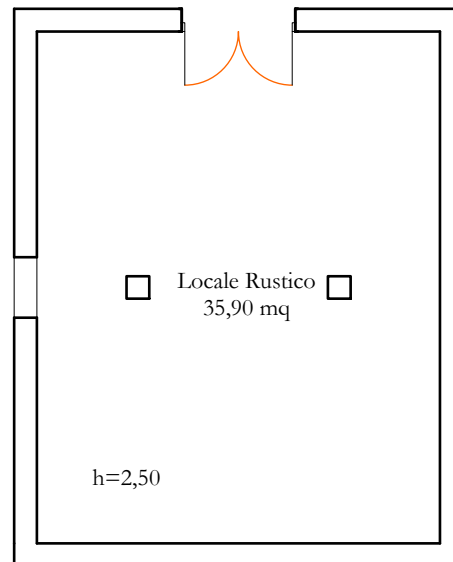

Superficie netta Piano Terra (Snpt)

Snpt = 33,70 mq

Superficie lorda commerciale Piano Terra (Slcpt)

Slcpt = 43,70 mq

Superficie netta Piano Primo (Snpp)

Snpp = 35,90 mq

Superficie lorda commerciale Piano Primo (Slcpp)

Slcpp = 43,70 mq

Superficie netta totale (Snt)

Snt = Snpt+Snpp = 33,70+35,90 = 69,60 mq

Superficie lorda commerciale totale (Slct)

Slct = Slcpt+Slcpp = 43,70+43,70 = 87,40 mq



Scala 1:100

Il CTU  
Ing. Gianfranco CHIAPPETTA